

15 CCD
POINTS
APPROVED

6 CPD
POINTS
(Ref. no.: IEM18/SWAK/347/C)
APPROVED

RM ~~2500~~

Learning Materials
Sponsored by
CIDB

RM 500

*SEATS ARE LIMITED

*Enjoy 15% discount for
CIDB/ACEM/IEM & Swinburne Alumni

BIM PROFICIENCY TRAINING

BIM CONCEPT & THEORY

OBJECTIVE: ●

The program explains and discusses BIM concept and theory, its benefits to the organizations, challenges and opportunities, case studies and the implementation. The participants will be able to discuss the impact of BIM deployment on their organizations, e.g. on their work practices, contracts, IT infrastructure and skills development

BIM CONCEPT & THEORY: ●

The module is specifically designed for the individual or organization that are involved in the construction and keen to explore new technology with the aim to bring awareness of the recent development in Building Information Modelling (BIM). The program explains and discusses BIM concept and theory, its benefits to the organizations, challenges and opportunities, case studies and the implementation. The participants will be able to discuss the impact of BIM deployment on their organizations, e.g. on their work practices, contracts, IT infrastructure and skills development.

● COURSE OUTCOME

- Understand the important of project information and collaboration;
- Understand the need for client leadership to successfully implement BIM;
- Recognize the importance of BIM and understand common BIM terminology;
- List the most common BIM-based applications;
- Understand BIM tools and implementation challenges;
- Understand barriers for BIM implementation; Understand the benefits of greater collaboration and integration in design and construction and how BIM supports it.

BIM PROFICIENCY TRAINING

BIM CONCEPT & THEORY

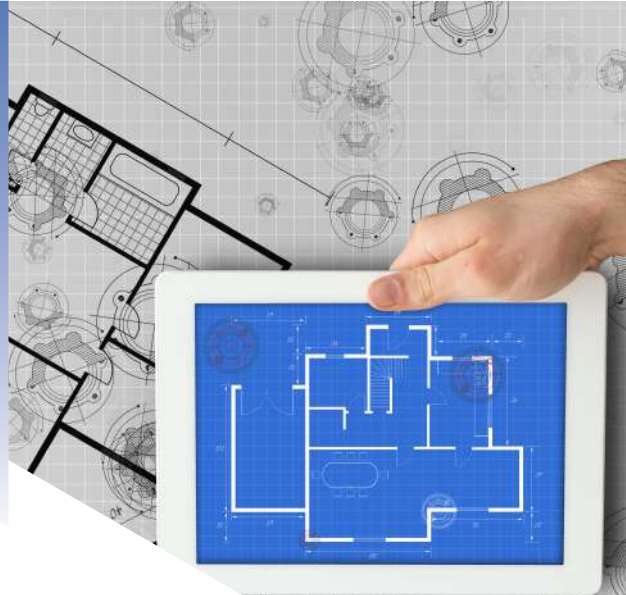

SUMMARY OF THE PROGRAM

- Effective deployment of BIM Requires project stakeholder to work together from the early stage of the project;
- Integrated Project Delivery (IPD) was introduced as a project delivery approach that integrates people, system, business structures & practices into a process to reduce waste and optimize efficiency throughout project life-cycle;
- People are the main issue that hindered the successful implementation of IPD in the project. Client leadership is an important factor in establishing a framework for IPD implementation.

COURSE OUTLINE:

- Construction Industry Scenario
- Introduction To BIM
- BIM Implementation
- BIM Collaboration

WHO SHOULD ATTEND:

- Architects
- Draught Person
- Project Managers
- Owners
- Developers
- Engineers
- Quantity Surveyors
- Designers
- Contractors
- Students

FOR MORE INFORMATION:



+60 82 260636



swinburne.edu.my/shortcourses



sutsshortcourses@swinburne.edu.my



**Swinburne University of Technology Sarawak
Campus, Jalan Simpang Tiga, 93350 Kuching,
Sarawak, Malaysia**



**SWIN
BUR
NE**

SWINBURNE
UNIVERSITY OF
TECHNOLOGY
SARAWAK CAMPUS